

# Creating a list in the Songs menu

## Access a list through the Songs menu

Choose Add List... from the Songs menu

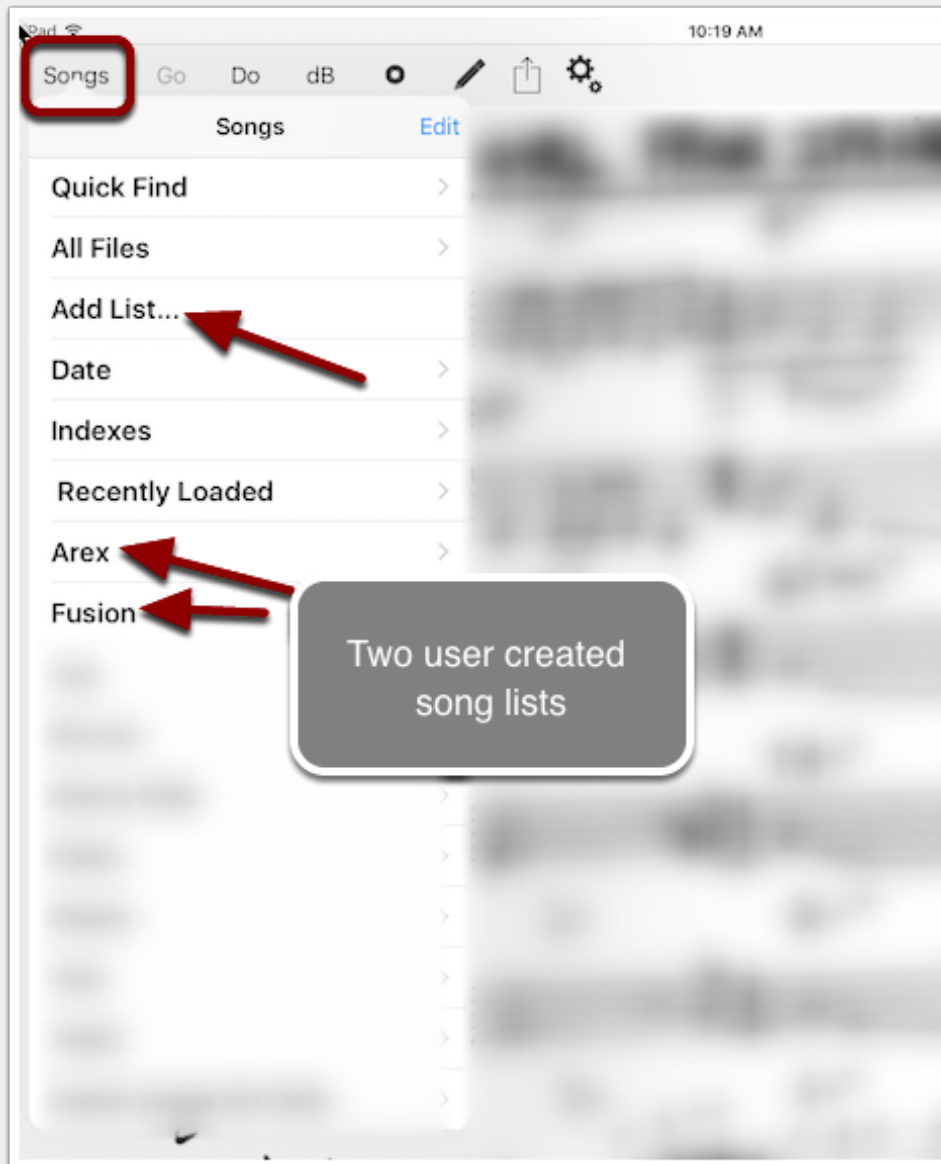

# Creating a list in the Songs menu

## Add songs in the list and choose Save List when done

Note that all songs in a list will be auto alphabetized. Once you choose Save List, it will appear in the Songs menu.

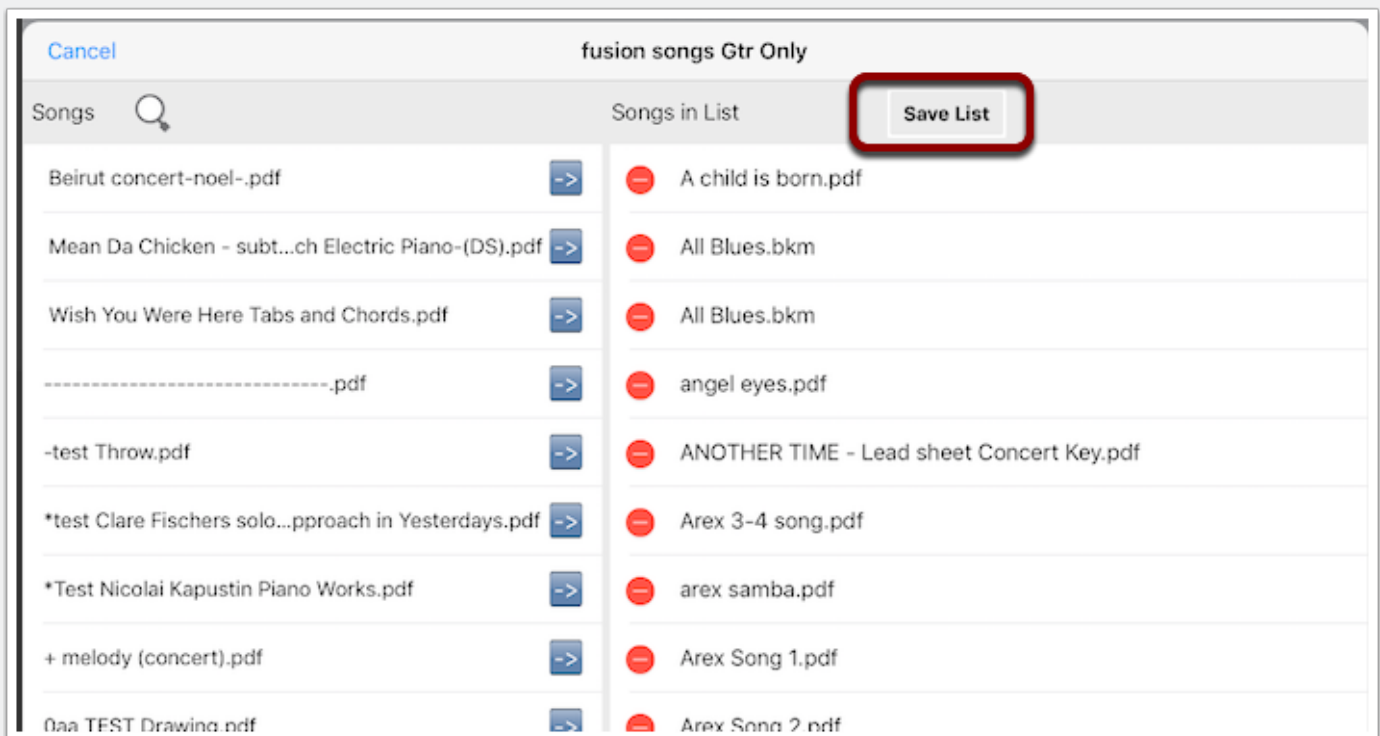

# Creating a list in the Songs menu

**Access these song lists in the set list editor. Create a new set list or modify an existing set list.**

Press the magnifying glass in the set list editor. Select Lists

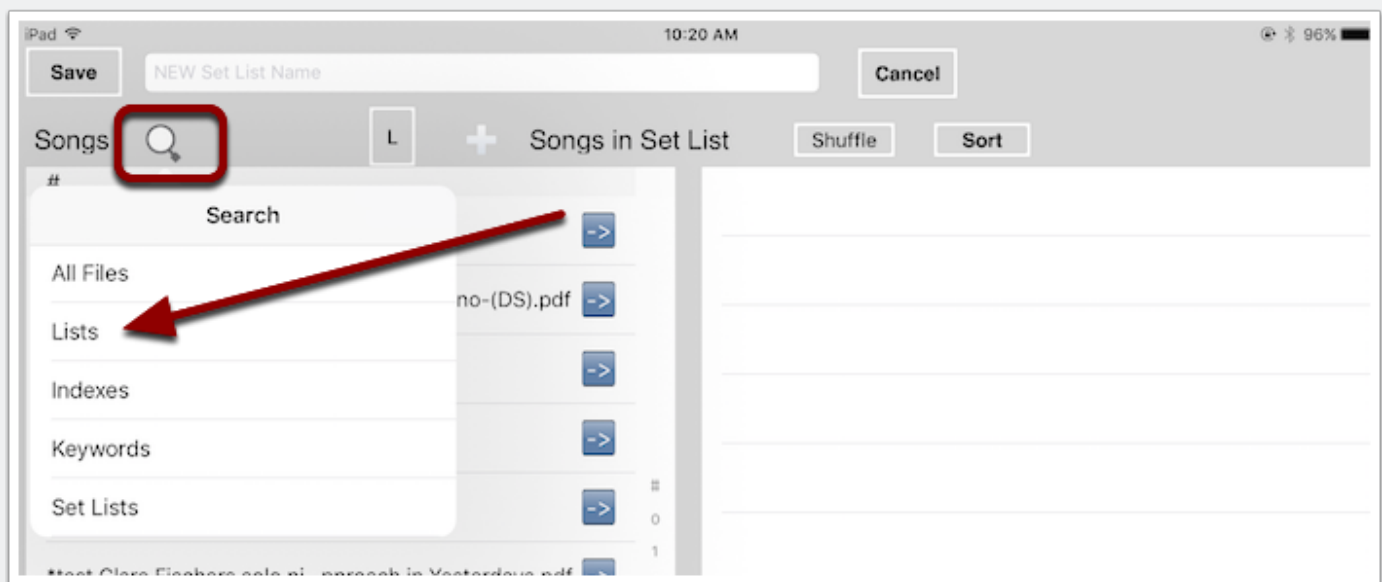

# Creating a list in the Songs menu

## Select a list to view

All of your lists will be displayed. Choose one

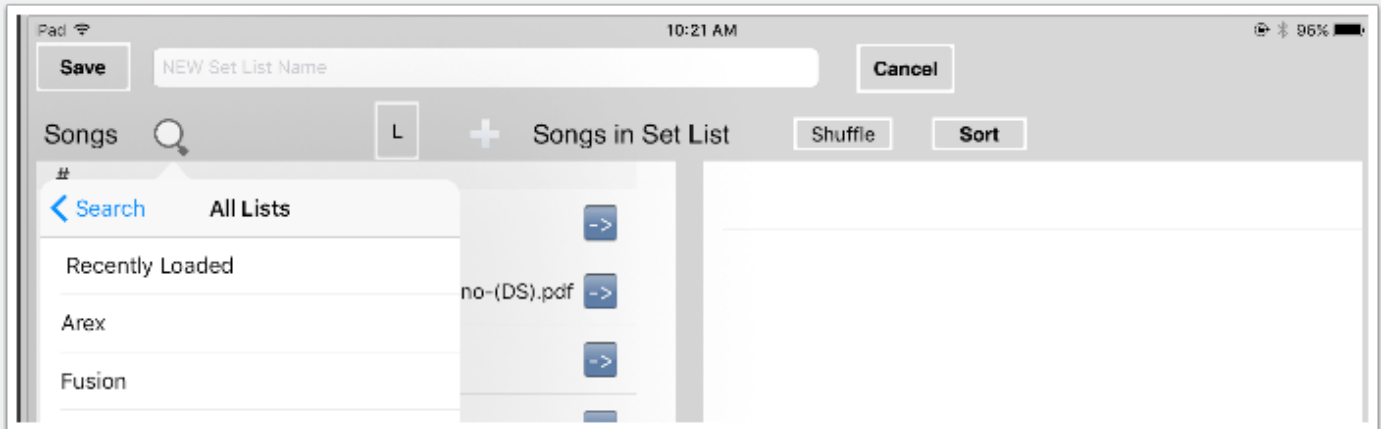

# Creating a list in the Songs menu

## Choose songs from the list to add to the set list

The songs will be in alphabetical order in the list. You can scroll or use the find field at the top to select songs. Name your set list and choose Save when done.

